

Welcome to Campus Parent!

The Campus Parent app puts school information at your fingertips with real-time access to announcements, assignments, attendance, grades, schedules, and more!

Logging in to the App

The Campus Student and Campus Parent apps provide the same tools as the browser version, with the benefit of the option to Stay Logged In and receive push notifications.

1. Download the app from the App Store or Google Play
2. Search for your **District Name** and **State**, entering at least 3 characters of your district's name to search. Select your district from the list.
3. Enter your **Username** and **Password**
4. If using a secure, private device, mark **Stay Logged In** to receive mobile push notifications.
5. Click the blue **Log In** button.

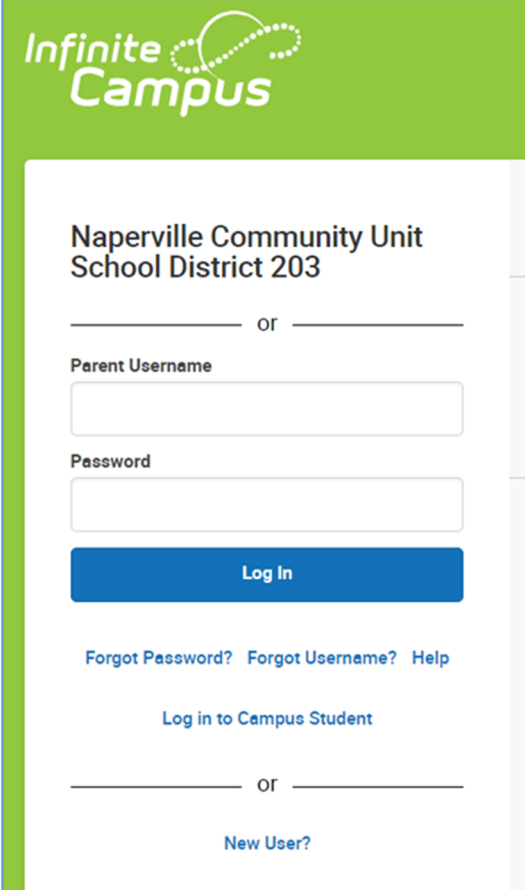

The screenshot shows the login interface for the Infinite Campus app. At the top, the 'Infinite Campus' logo is displayed on a green background. Below the logo, the text 'Naperville Community Unit School District 203' is centered. There are two horizontal lines with 'or' between them, indicating a search or selection area. Below this, there are two input fields: 'Parent Username' and 'Password'. A blue 'Log In' button is positioned below the password field. Underneath the button, there are three links: 'Forgot Password?', 'Forgot Username?', and 'Help'. Below these links is a link that says 'Log in to Campus Student'. At the bottom, there are two more horizontal lines with 'or' between them, and a link that says 'New User?'.

Logging in from a Web Browser

Students and parents have different login pages.

1. Visit <https://infinitecampus.naperville203.org/campus/portal/parents/naperville.jsp>
2. Enter your Parent Username and Password
3. Click the blue Log In button

Welcome to Campus Parent!

Have an Activation Key?

1. Click **New User?**
2. Enter your **Activation Key** in the space provided and then **Submit**.

Infinite Campus simple || powerful

Naperville Community Unit School District 203

_____ or _____

Parent Username

Password

Log In

Forgot Password? Forgot Username?

Log In to Campus Student

_____ or _____

New User?

New User?

Activate your Campus Portal account by entering the activation key sent to you in the space provided below.

If you do not have an activation key, please contact Parent Support at parentsupport@naperville203.org.

Activation Key *

Submit

Back to Login

Change the language on the Campus Parent App

At the bottom of the screen you can click the dropdown next to the word Language to select one of four available languages.

Infinite Campus simple || powerful

Campus Parent

Naperville Community Unit School District 203

_____ o _____

Nombre de usuario (Padres)

Contraseña

Iniciar sesión

Olvide la contraseña Olvide el nombre de usuario Ayuda

Iniciar sesión en Campus Student

_____ o _____

¿Nuevo Usuario?

Anuncios

Tuesday 05/31/2022

If you have forgotten your username or password, please click on the "Forgot Password?" or "Forgot Username?" links located below the Username/Password fields. If you are still experiencing login issues please contact Parent Support at parentsupport@naperville203.org.

Friday 07/26/2019

Get your App today!

Infinite Campus Parent & Campus Student (grades 6th - 12th) apps are available (free) for iPhone and Android.

CAMPUS

Download on the App Store

Download on the App Store

Google play

Google play

After downloading and launching either the Student or Parent app:

1. Enter part of the District name (**Naperville 203**), select state **IL**, click on Search.
2. Select **Naperville Community Unit School District 203** to access our district's system.
3. Enter your username and password to log in.

© 2003-2023 Infinite Campus

Language: Español

Welcome to Campus Parent!

How do I get Notifications?

Notifications are available through the Campus Student and Campus Parent mobile apps. You may need to enable notifications on your device.

1. After logging in, click the **user menu** in the top right and then click **Settings** then **Notification Settings**.
2. From there, indicate which types of notifications you'd like to receive and set the threshold for notifications. For example, indicate if you only want to receive Assignment notifications if the score is below 70%.
3. Click **Save**.

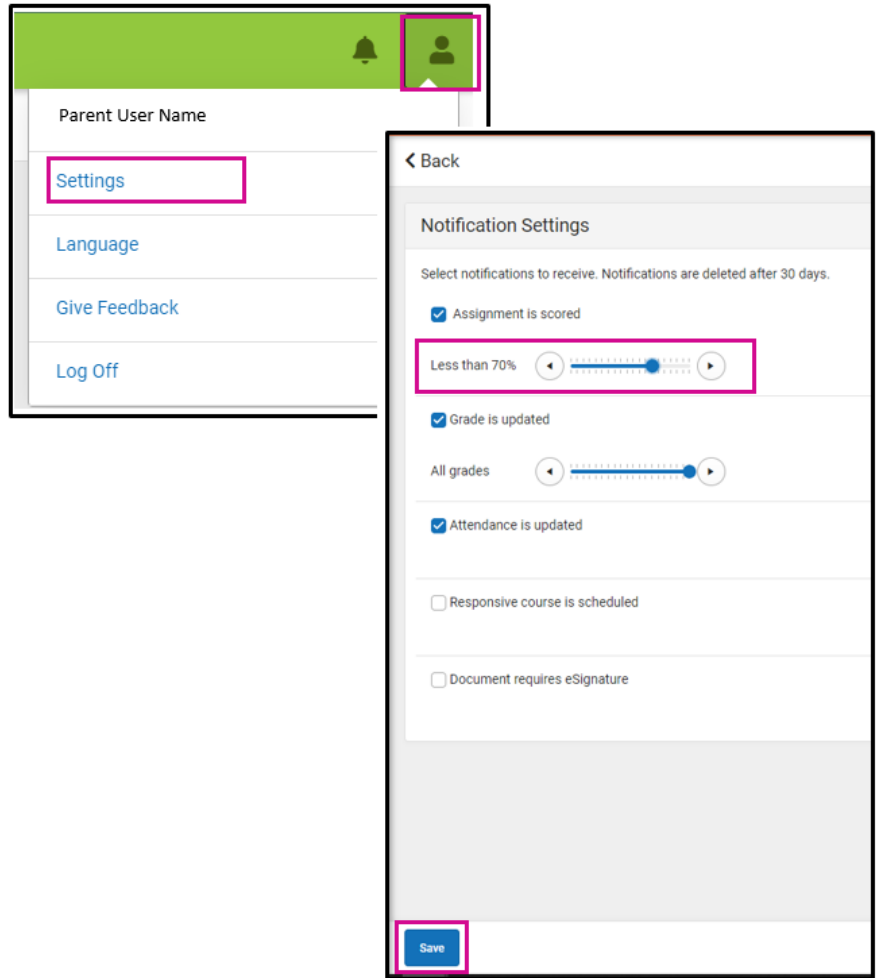

Need Help?

Contact the Parent Support at parentsupport@naperville203.org.